

# SPECIFICATIONS

## ELECTRICAL

FREQUENCY RANGE \_\_\_\_\_ DC - 67 GHz  
 VSWR (MAX) \_\_\_\_\_ <1.35:1 MAX  
 POWER (AVG. MAX.) \_\_\_\_\_ 20 Watts @25°C  
 IMPEDANCE \_\_\_\_\_ 50 OHMS  
 RF LEAKAGE \_\_\_\_\_ >90 dBc  
 OPERATING TEMP. RANGE \_\_\_\_\_ -55 - 125°C  
 PHASE MATCHING \_\_\_\_\_ ±10°(TO P/N's 6782-0000-00  
 AND 6781-0000-00)

## MATERIAL AND FINISH:

HOUSING, COUPLING NUT \_\_\_\_\_ GOLD PLATED  
 STAINLESS STEEL  
 CONTACT \_\_\_\_\_ GOLD PLATED  
 BERYLLIUM COPPER

DIELECTRIC \_\_\_\_\_ PTFE

## MARKING

PART LOOKS LIKE PRODUCT IMAGE ABOVE.  
 PART MARKING ORIENTATION AND FORMAT AS SHOWN.  
 MARKING TO BE AS LARGE AS POSSIBLE, CLEAR, READABLE.  
 YYWW EQUALS DATE CODE.

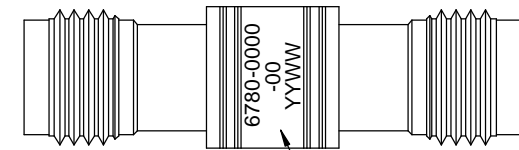
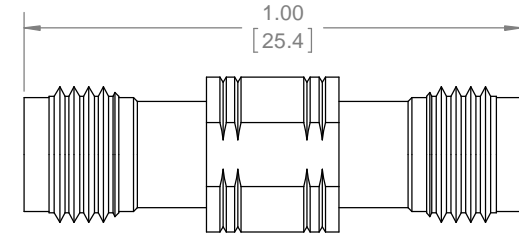
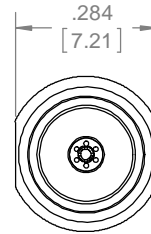

MARKING AREA

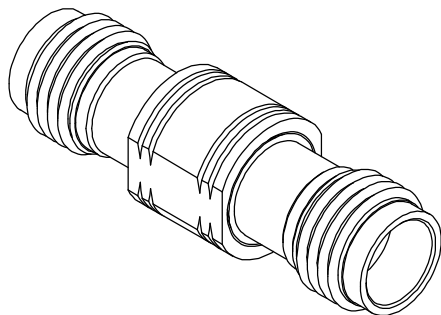

REVISIONS				
REV	DESCRIPTION	ECO #	DATE	APPROVED
X1	PRELIMINARY RELEASE		4/13/15	T.KUHN

QTY.	PART NUMBER	DESCRIPTION	ITEM NO.
X	6780-0000-00	ADAPTER, 1.85mm-f/f, DC-67 GHz, 20W	
1	TA-6780-0000-00U	ASSY, ADAPTER, 1.85mm-f/f, DC-67 GHz, 20W, UNMARKED	1

DRAWING PRACTICES PER ANSI-Y14.5 MIL-STD-100 & 1000	UNLESS OTHERWISE SPECIFIED TOLERANCES IN:
DIMENSIONS ARE IN INCHES AND APPLY BEFORE / AFTER PROCESSING	DECIMALS INCH [MM]
SURFACE ROUGHNESS 63	.X" .05" [1.27]
FINISH:	.XX" .03" [.76]
SEE NOTES	.XXX" .010" [.25]
MATERIAL:	ANGLES ±0°30'
SEE NOTES	REMOVE ALL BURRS/SHARP W/ BREAK / R OF .003" TO .0005"
NOTE: THIS DRAWING INCORPORATES THIRD ANGLE PROJECTION.	UNLESS OTHERWISE NOTED DIAS CONCENTRIC <.003 T.I.R.
INTERPRET IAW ANSI Y14.5-1982	DO NOT SCALE PRINT

DRAWN MCCORMICK	DATE 4/13/15
CHECKED MCCORMICK	DATE 4/13/15
ENG. APPR. MCCORMICK	DATE 4/13/15



Phone: 603-222-2256 Fax: 603-222-2259  
 150 Dow Street, Manchester, NH 03101

ADAPTER, 1.85mm-f/f, DC-67 GHz, 20W

SIZE	CAGE CODE	DRAWING NUMBER	REV
B	3HT76	6780-0000-00	X1
SCALE	PLATED AREA SQ. IN	SHEET 1 OF 1	